

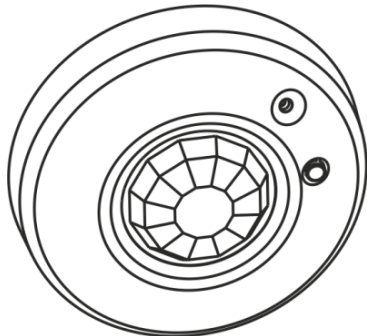

Astra-8

Dual Channel (infra-red + acoustic)

Detector



User guide

Manufacturer:
ZAO NTC TEKO
420108 Kazan, Russia
Gafuri 71
+7843 528-03-69
export@teko.biz
www.teko.biz

Made in Russia

rev. 8-v1_5_instr_en

1 FUNCTION

The detector is intended for detection of unauthorized access into an enclosed area, detection of glass breaking of glazed constructions of an enclosed area and generation of alarm notification by opening contacts of dedicated alarm relay.

2 DETECTION ZONES

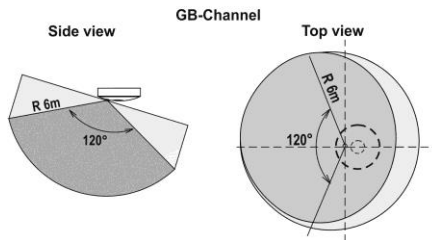
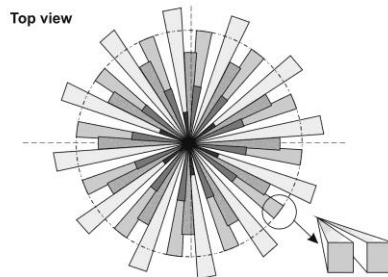
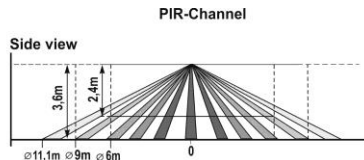

3 SPECIFICATIONS

Range of detectable moving speed, m/s.....from 0.3 up to 3.0
Power supply voltage, V.....from 8 up to 15
Current consumption, mA, max..... 21
Overall dimensions, mm..... diameter 91
height 31

Operating Conditions

Temperature range, °C..... from - 20 up to +50
Relative air humidity, % up to 95 at +35 °C
without moisture condensation

4 DELIVERY SET

Delivery set includes: dowel – 2 pcs., screw – 2 pcs.

5 MODES OF OPERATION

Mode	Plug	Jumper
High detectability of IR channel	PIR	
Normal detectability of IR channel		
High sensitivity of AC-channel	GB	
Normal sensitivity of AC-channel		
“Alarm memory” ON	Mem	
“Alarm memory” OFF		
AC-channel TEST	Tst	See p. 9
Ind. ON	Ind	
Ind. OFF		

6 INSTALLATION PLACE

- 1) Recommended installation height is **2.4-3.6 m** and at a distance not more than **6m** from the most distant spot of protected glass.
- 2) Detector should be installed on the ceiling (or any other horizontal surface) **strictly horizontally**.
- 3) The detector cannot be used in premises with high level of acoustic interference.
- 4) Alarm loop and power supply wires should be located far from power cables.

To eliminate false alarm hazards

- 1) It is recommended to close all doors, air-vents, switch off possible sources of intense air flows (fans, air-conditioners) and acoustic interferences (loudspeakers, etc.) in the room during protection period.
- 2) The detector's location should provide direct visibility of all secured glass parts; masking the detector with decorative curtains is not allowed, as sensitivity may be lost.

Not recommended installation places

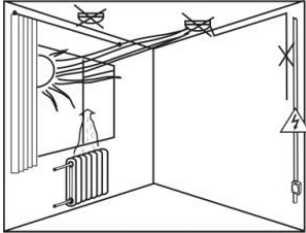

7 INSTALLATION ORDER

- 1) Remove cover

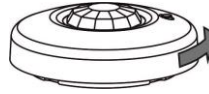

- 2) Remove PCB

- 3) Install on the ceiling

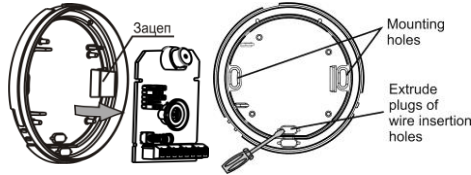

- 4) Install Pcb and perform wiring (see p. 8).

- 5) Perform PIR and AC test (see p. 9)

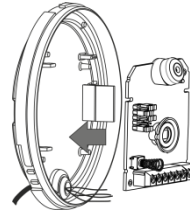

8 WIRING

Perform wiring to detector's terminals in accordance with control panel operating manual.

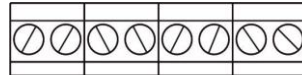

TMP Relay-GB Relay-PIR+12V GND

TMP – detector tampering control terminals;
RELAY-PIR, RELAY-GB – terminals for detector connection to alarm loop;
+12V, GND – power supply terminals.

9 TEST

AC-channel:

- 1) Remove jumpers from **Mem** and **GB** plugs, install jumper on **Ind** plug.
- 2) Power detector ON. LED starts flash during **60 sec**.
- 3) During this time close shortly **Tst** plug using screwdriver. **AC-channel TEST** mode switches for **8 min**.
- 4) Close detector.
- 5) Apply non-destructive strike to the most distant part of the protected glass.
- 6) At the detection moment LED should light up for **4s** and relay should open (check with control panel) or LED should double-flash one time.

PIR-channel:

After the end of the AC-channel testing mode (8 min), perform a TEST-pass.
To detect sensitive zones pass through detection zone with the speed of 0.3-3 m/s by enabling of the LED (on for **4 sec** and then blinks **1 time**).



10 WARRANTY

The operation warranty period is 5 years from the date of operation start-up but no longer than 5 years 6 months from the date of manufacturing subject to the requirements of the User guide.