



Astra-3731

Wireless temperature detector



User guide

Manufacturer:

TEKO-TD

Prospekt Pobedy str. 19

420138 Kazan, Russia

+7(843) 528-03-69

export@teko.biz

www.teko.biz

Made in Russia

rev. 3731-v1_4_instr_en

1 FUNCTION

• The detector is designed to measure the temperature at the installation site and transmit by radio to the Security Hub.

• Temperature control is carried out using a built-in temperature sensor and / or a DS 18B20 temperature sensor (not included in the delivery set) connected to the detector terminal block. Maximum cable length - 3 m

ATTENTION! The terminal block must not be used to connect other sensors!

• The range of temperatures measured by the detector is:

a) built-in sensor – from - 30 to + 55 °C;

b) external temperature sensor DS 18B20 – from - 55 to + 125 °C.

• If an external temperature sensor is connected, the measurement results are transmitted alternately from each sensor.

The sending frequency is 12 sec. or 60 sec, set by a jumper (see the table in p. 4).

• The detector operates only in radio mode 2, the jumper on the **R_{mod}** plug must be installed.

2 SPECIFICATIONS

Wireless coverage range, m.....100

Operating frequencies, MHz:

- frequency 1.....433.42

- frequency 3.....434.42

Power supply voltage, V.....from 2.6 to 3.6

Overall dimensions, mm.....109 × 34 × 27

Operating Conditions

Temperature range, °Cfrom - 30 to + 55

Relative air humidity, %..... up to 95 at + 40 °C without moisture condensation

3 DELIVERY SET

The detector delivery set includes fastening parts (screws - 2 pcs., dowels - 2 pcs.), jumpers - 4 pcs.

(installed), battery (Lithium, 3.6V, AA) - 1 pc., user guide - 1 pc.

4 OPERATING MODES

Setting the operating mode of the detector is possible within no more than 10 minutes after installing the battery!

ATTENTION! The jumper must be installed on the R_{mod} plug!

Operating mode	Plug	Jumper
Radio mode 2 (compatible with Security hub)	R_{mod}	
Frequency of sending measured temperature	R_{tst}	12 sec
		60 sec
Frequency 1 (compatible with Security Hub)	Lit	
Frequency 3		
External temperature detector connected	Ext	
External temperature detector is not used		

5 INDICATION

Indication	Detector's LED
Boot time	Lights up for 1 to 20 sec
Norm	Off
Tampering	Off
Power failure	3-times flashing 25 sec period

Note - When the message "**Power failure**" appears, the battery must be replaced within **one week**.

6 ADDING PROCEDURE

- 1) Open detector's cover
- 2) Set operating frequency and frequency of sending measured temperature using jumpers.
- 3) Start registration on the Security Hub mobile app. Registration starts for 45-60 sec.
- 4) Install battery into detector.

In case of unsuccessful registration, remove the battery, wait at least 20 sec. and repeat the procedure.

- 5) Check the adding in the Security Hub mobile or desktop App.

7 INSTALLATION PLACE

The detector is not intended for installation on metal structures.

To correctly measure the room temperature:

- 1) Place detector at a height of 1.0-1.5 m above the floor and only on internal walls,
- 2) do not hide behind furniture, curtains, etc.,
- 3) Place away from heating devices, from sources of cold, avoid direct sunlight and air jet from the air conditioner.



8 INSTALLATION ORDER

- 1) Remove the cover
- 2) Remove PCB

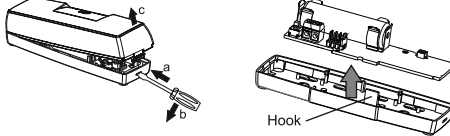

- 3) Break out the plugs of the mounting holes and, if necessary, the wire entry holes.

ATTENTION!

To safely break out the plugs, fix the base on a hard surface

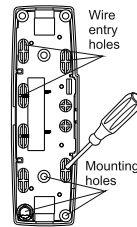

- 4) Fix detector's base

- 5) Place the PCB

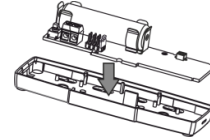

- 6) Connect external temperature detector wires (if necessary)

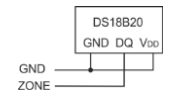

- 7) Place detector's cover.

9 WARRANTY

The operation warranty period is 5 years from the date of operation start, but no longer than 5 years 6 months from the date of manufacturing subject to the requirements of User guide.