

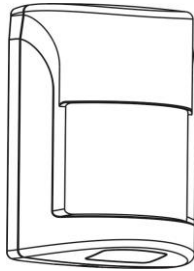

Astra-5131 ver. A
Wireless Optic-Electronic
PIR Motion Detector



User Guide

Manufacturer:
ZAO NTC TEKO
 420108, Russia, Kazan,
 Gafuri str., 71
 Tel.: +7(843) 528-03-69
export@teko.biz
www.teko.biz

Made in Russia

Rev. 5131-av5_0_instr_en

1 FUNCTION

The detector is designed to detect intrusion into the protected area of an enclosed space, generate an alarm notification and transmit the notification via radio to the wireless receiver Astra-WE 433 or Astra-812 Pro or Security hub.

The detector provides measurement and transmission via radio (at intervals of 25-30 sec) of the following parameters:

- a) residual capacity of the battery with display in the event log when the values of 30, 20, 10% are reached;
- b) ambient temperature (processed only in Control Panel).

2 DETECTION ZONES

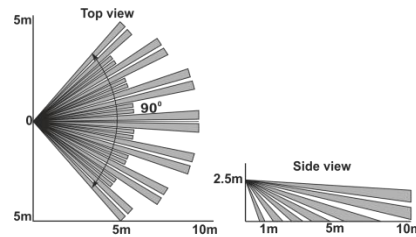

3 SPECIFICATION

Range of detectable moving speed, m/sec	from 0.3 to 3.0
Wireless coverage range (line-of-sight), m	300
Operating frequency range, MHz	433
Power supply voltage, V	from 2.2 to 3.0
Overall dimensions, mm	70 × 51 × 42

Operating Conditions

Temperature range, °C	from - 20 to + 50
Relative air humidity, %	up to 98 at + 40 °C without moisture condensation

3 DELIVERY SET

Detector delivery set includes: dowel – 2 pcs., screw – 2 pcs., 3.0 V battery (CR123A) - 1 pcs.(Installed), user guide – 1 copy.

5 MODES OF OPERATION

ATTENTION! The setting of the detector's operating modes is performed before the detector's registration and within 60 minutes after the installation of the battery.

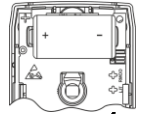

The detector operating modes are set by closing the metallized contacts **RMOD** and **LIT** on the PCB.

Configuration order:

- 1) Install or reinstall the battery if more than 60 minutes have passed since the activation of the battery. Wait at least 10 sec.
- 2) Close the **RMOD** contact (at least 10 sec.) until the indication appears.
- 3) By turning on the indicator, determine the set mode:
 - 2x flash - operation in mode 2.
- 4) Close the **LIT** contact (at least 10 sec.) until the indication appears.
- 5) By turning on the indicator, determine the set mode:
 - 1x flash – frequency channel "1",
 - 3x flash – frequency channel "3".

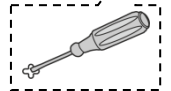

ATTENTION! When changing modes on a registered detector, re-register the detector!

6 REGISTRATION

- 1) Open detector's cover
 - 2) Using the metallized **RMOD** and **LIT** contacts of the detector set the required radio operation mode and the operating frequency of the detector in accordance with the receiver.
 - 3) Start the registration mode on the receiver in accordance with the Astra-812 Pro Configuration **Manual** (via the keypad) or built-in to the PKM Astra Pro or with Security Hub mobile App. The mode starts for **45-60** sec.
 - 4) Start registering the detector by installing the battery.
- In case of **unsuccessful** registration, remove the battery and repeat the procedure. Before switching on again, wait at least 20 sec. or briefly insert the battery in reverse polarity.
- 5) Check the registration, according to the method described in the **Manual**.

7 INSTALLATION PLACE

- 1) Recommended installation height is 2.3-2.5 m.
- 2) Install the detector on bearing walls and carriers.
- 3) To **eliminate false alarms** in the room for the period of protection, close the doors, vents, turn off possible sources of strong air currents (fans, air conditioners).

Not recommended installation places

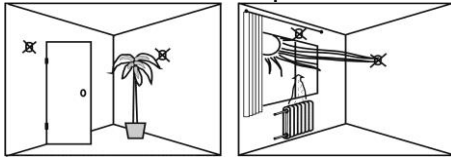

8 INSTALLATION PROCEDURE

- 1) Remove cover
- 2) Remove PCB

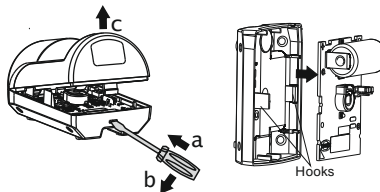

- 3a) Installation on the wall

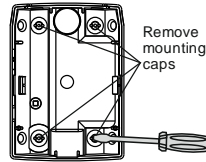

- 3b) Installation in the corner

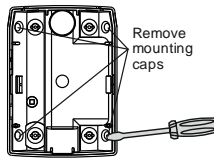

- 3c) Installation with the bracket (in the delivery set)

ATTENTION! For safe removing of the caps fix the detector base on a hard flat surface.

- 4) Seal all holes on the base with a sealing material.
- 5) Install the PCB.
- 6) Perform **TEST-pass** (see p.9)

9 TEST-PASS

- 1) Turn on the power of the detector. The indicator flashes 1 time/2 sec for a period of no more than 60 sec.
- 2) Close the detector's cover.
- 3) After the detector enters the operating mode, perform a **TEST-pass** of the protected area at a speed of **0.3 m/sec** and **3 m/sec** to determine the sensitivity zone.

At the moment of detection (the indicator lights up for 1 sec.), stop, mark this position, then return two steps back and continue moving. Repeat the **TEST-pass** in the opposite direction.

- 4) Check the operability of the detector:

- pass through the detection zone of the detector,
- check the issuance of the "alarm" notification on the receiver leds.

10 WARRANTY

Operational warranty period: 5 years from the date of commissioning, but no more than 5 years 6 months from the date of manufacture and subject to current user guide requirements.