

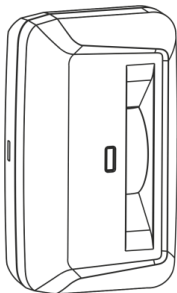

## Astra-5131 ver. C

(Curtain-type lens)

Wireless motion detector



User Guide

Manufacturer:  
**ZAO NTC TEKO**  
 Gafuri str. 71  
 420108 Kazan, Russia  
 +7(843) 528-03-69  
[export@teko.biz](mailto:export@teko.biz)  
[www.teko.biz](http://www.teko.biz)

Made in Russia

Rev. 5131sh-v2\_3\_instr\_en

### 1 FUNCTION

The detector is intended for detection of an intrusion into a secure space of an enclosed area, forming an alarm notification and transmitting alarm signal to the Security Hub via radio.

The detector provides measurement and transmission via radio:

- a) the residual capacity of the battery in operating **Mode 2** (see below) when the capacity value is 30, 20 and 10%.
  - b) ambient temperature (processed by Central Control Panel or Security Hub)
- The transmission interval is 12 s (with **Rtst** plug jumpered) or 60 s (with **Rtst** plug opened).

### 2 DETECTION ZONE

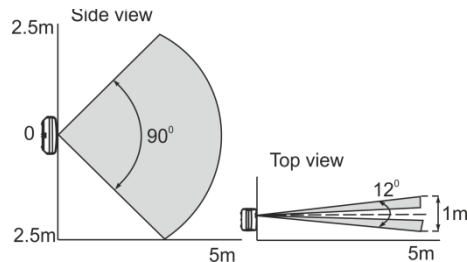

### 3 SPECIFICATIONS

Range of detectable moving speed, m/sec..... from 0.3 to 3.0  
 Wireless coverage range, m..... 300  
 Operating frequency range, MHz ..... 433  
 Power supply voltage, V ..... from 2.4 to 3.0  
 Dimensions, mm ..... 85 × 50 × 30

#### Operating Conditions

Temperature range, °C..... from - 20 to + 50  
 Relative air humidity, %..... up to 93 at + 40 °C  
 without moisture condensation

### 4 DELIVERY SET

Detector delivery set includes: bracket - 1 pc., dowel - 2 pcs., screw - 2 pcs., jumper - 4 pcs. (installed), battery (CR 123A, 3V) - 1 pc. (installed), user guide - 1 copy.

### 5 OPERATING MODES

**Setting the detector's operating mode and indication of notifications is possible within 10 minutes after activating the battery!**

Mode		Plug	Jumper
<b>Mode 2*</b> (compatible with Security Hub)		<b>Rmod</b>	
<b>Mode 1</b>			
Test signal transmission period**	12 sec.	<b>Rtst</b>	
	60 sec.		
<b>Frequency 1</b> (433,42 MHz) (compatible with Security Hub)		<b>Lit</b>	
<b>Frequency 3</b> (434,42 MHz)			
High detectability		<b>PIR</b>	
Normal detectability			
* Factory setting. ** For Mode 2 only			

## 6 REGISTRATION

### ATTENTION!

When registering, the operating mode of the radio and the operating frequency of the detector must correspond to receiver.

- 1) Remove detector cover.
- 2) For operating with Security Hub set **Frequency 1** and **Mode 2** using jumpers.
- 3) Start registration on the receiver according to the **Manual**. Registration starts for **45-60 sec**.
- 4) Pull out the insulator or install a battery.

In case of unsuccessful registration, remove the battery and repeat the procedure. Before switching on again, wait at least 20 sec. or briefly set the battery in reverse polarity.

- 5) Make sure that the registration is successful according to the **manual**.

## 7 INSTALLATION PLACE

- 1) It is allowed to install the detector on a wall, ceiling, in a door/window opening, in the corner of the room.
- 2) Mount the detector on a load-bearing wall or other load-bearing structural elements.

### To eliminate false alarms

It is recommended to close all doors, air-vents, switch off fans, air-conditioners and other sources of intense air flows in premises during protection period.

### Not recommended installation places

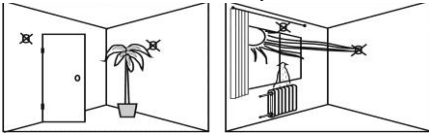

## 8 INSTALLATION ORDER

- 1) Remove the cover

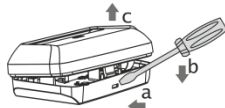

- 2) Remove the PCB

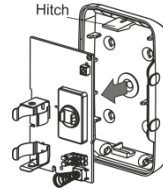

- 3a) Mounting on a wall or ceiling

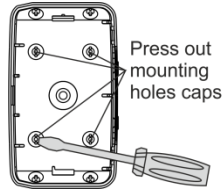

- 3b) Mounting in a corner

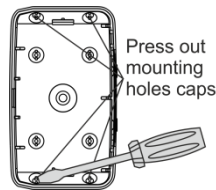

**Attention!** For safe extrusion of the caps fix the detector base on a hard flat surface.

- 3c) Mounting with a bracket

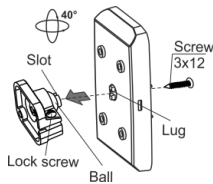

- 4) Install the PCB.
- 5) Install the battery.
- 6) Perform **TEST-pass** (see p. 9).

## 9 TEST-PASS

- 1) Install jumper on the **PIR** plug.
- 2) Power up the detector (install the battery). LED flashes once every 2 seconds for a period of not more than 60 sec.
- 3) Close the detector cover.
- 4) After the detector enters the operating mode, perform a **TEST-pass** across the protected area at a speed of 0.3 m/sec to determine the sensitivity zone. At the moment of detection (LED lights up for 1 sec), stop, mark this position, go back two steps, then continue moving forward. Repeat the test pass in opposite direction.

## 10 WARRANTY

The operation warranty period is 5 years from the date of operation start-up but no longer than 5 years 6 months from the date of manufacturing subject to the requirements of the user guide.