

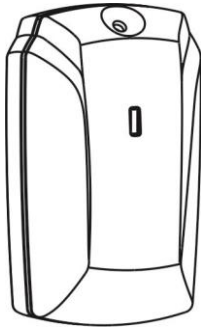

Astra-6131

Wireless glass break detector



User guide

Manufacturer:
ZAO NTC TEKO
 Gafuri str. 71
 420108 Kazan, Russia
 +7(843) 528-03-69
export@teko.biz
www.teko.biz
Made in Russia

Rev. 6131-v3_3_instr_en

1 FUNCTION

The detector is designed to detect the destruction of glass, generate an alarm notification and transmit a notification via a radio to the Security Hub controller.

The detector supports measurement and transmission over the radio (in radio mode 2) of the residual capacity of the battery with display in the event log when values of 30, 20, 10% are reached.

The frequency of transmission of values is equal to 12 sec. (Rtst jumper installed) or 60 sec. (Rtst jumper not installed).

The detector supports connection of the hard-wired detectors with normally closed contacts. The length of the wire is no more than 1.5 m.

2 DETECTION ZONES

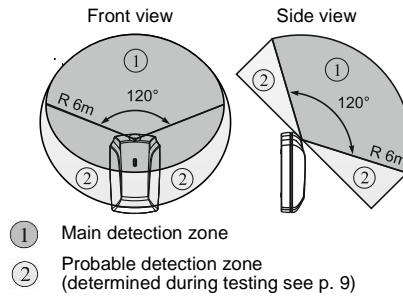

3 DELIVERY SET

Delivery set includes: dowels - 2 pcs., screws - 2 pcs., jumpers - 5 pcs. (installed), battery (CR123A, 3V installed) - 1 pcs., user guide - 1 copy., label - 2 pcs.

4 SPECIFICATIONS

Acoustic channel operating frequencies:
 - first (high), kHz from 4 to 6
 - second (low), Hz from 100 to 200
 Wireless coverage, m..... 100
 Supply voltage, V from 2,6 to 3,2
 Overall dimensions, mm..... 87 × 54 × 28

Operating conditions

Temperature range, °C..... from - 20 to + 50
 Relative air humidity, % up to 98 at + 40 °C
 without moisture condensation

5 OPERATING MODES

Setting operating mode of the detector, as well as LED indication of notifications are provided within 10 minutes after battery insertion!

Mode		Plug	Jumper
Mode 2* (compatible with Security Hub)		Rmod	
Mode 1			
Test signal transmission period**	12 sec. 60 sec.*	Rtst	
Frequency 1* (compatible with Security Hub)		Lit	
Frequency 3			
Acoustic channel high sensitivity		GB	
Acoustic channel normal sensitivity*			
Zone input on		Ext	
Zone input off*			

* Factory setting.
 ** Only for radio mode 2

6 ADDING PROCEDURE

1) When using the detector with factory settings (Security Hub compatible), start adding from step 3), if it is necessary to change the operation mode of the detector, remove the detector cover (see p. 8).

2) For operating with Security Hub set **Frequency 1** and **mode 2** using jumpers.

3) Start registration on the Security Hub mobile app or web app. Registration starts for **45-60 sec.**

4) Activate the battery by pulling out the protective strip or re-install the battery.

In case of **unsuccessful adding**, remove the battery and repeat procedure. Before installing it on again, wait at least 20 sec. or briefly set the battery in reverse polarity.

5) Make sure that the adding is successful on the Security Hub mobile or desktop app.

7 INSTALLATION PLACE

1) Recommended installation height **not less than 2 m** and at a distance of **no more than 6 m** to the most distant point of the protected glass.

2) It is allowed to install the detector on the ceiling, wall, in window openings, between frames.

3) It is not allowed to operate the detector in a room with a high level of acoustic interference.

4) Place the alarm loop wires away from powerful power cables.

To eliminate false alarms

1) close the doors and vents in the room for the period of protection, turn off possible sources of strong air flows (fans, air conditioners) and acoustic interference (broadcast loudspeakers, etc.);

2) all areas of the protected glass must be within the direct line of sight of the detector; it is prohibited to mask the detector with decorative

curtains, since in this case, the loss of its sensitivity is possible.

Not recommended installation places

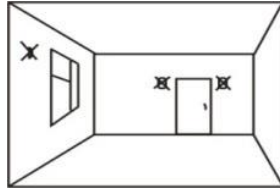

8 INSTALLATION PROCEDURE

1) Remove cover

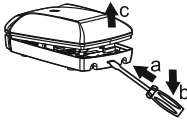

2) Remove PCB

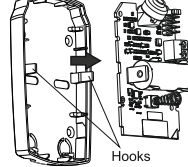

3) Fix the base.

ATTENTION! Fix the detector base on a hard surface to safely break out the plugs.

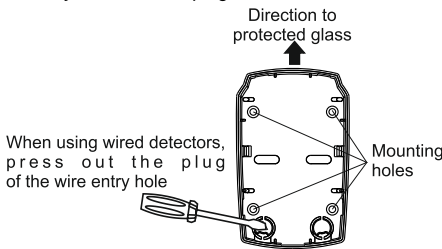

4) Install PCB.

5) When using hardwired detectors, fix the supplied wires in the **Zone**, **GND** terminals.

Place a jumper on the **Ext** plug.

6) Perform test of acoustic channel (see p. 9)

9 TEST

1) Install jumper on **GB** plug.

2) Turn on the detector. LED will turn on for no more than 20 sec.

3) Close the cover.

4) Using a glass break simulator, check the detector response for acoustic interference:

- for high-frequency - 2-fold blinking with a pause of 0.1 sec,

- for low-frequency - single switching on for 0.45 sec.

10 WARRANTY

Operational warranty period: 5 years from the date of commissioning, but no more than 5 years 6 months from the date of manufacture and subject to current user guide requirements.